

Floor Plan:
Lewisville-TX

3 Beds | 2 Baths | 1,657 sqft | Garage: Yes



Lewisville

With ultimate flexibility in mind, the Lewisville offers a beautiful open floorplan to gather everyone in comfort. Optional outdoor and bonus rooms easily transform this model into the perfect home to suit your unique needs.

- Flexible additions
- Open floorplan
- Perfect for a growing family or downsizing comfortably

Floor Plan:
Lewisville-TX

3 Beds | 2 Baths | 1,657 sqft | Garage: Yes



FP1

Floor Plan 1st Floor

Floor Plan:
Lewisville-TX

3 Beds | 2 Baths | 1,657 sqft | Garage: Yes

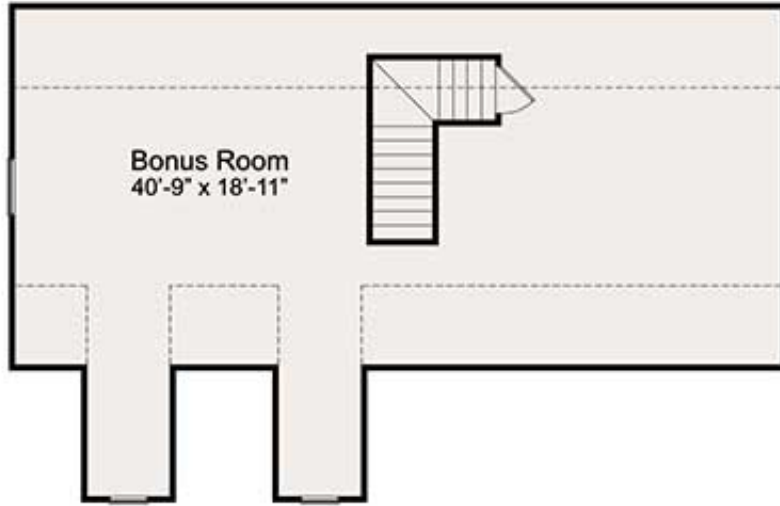

FP2 - Optional

Floor Plan 2nd Floor - Unfinished Bonus Room